

G3660 Push-to-Open Full Extension Slide

Max load 20kg · Push-to-open · Detachable · Bumper

Features

- Full extension (3 members)
- Push-to-open mechanism, no handle or knobs required for a sleek, modern look
- Drawer is easily opened by slightly pushing the front plate
- New mechanism PPD (pull protection device) minimises damage to slide
- Patented new mechanism PAE (push area expander, see ※1 below) may reduce swing during close, and the drawer can be opened even though the push position of front board (push area, see ※2 below) is slightly staggered with the centre
- Drawer / compartment is detachable by lifting the lever
- Passed 50,000 life cycle test

Parts Included

- Truss head tapping screw 4x12
- Hex key



Notes

- Do not apply strong shock. Otherwise, the drawer may be opened unexpectedly
- PPD is not for routine use
- Operate the push-to-open mechanism by pushing the centre part of the front plate. To widen the push area, adjust the gap with PAE
- PAE has no effect if the gap between drawer and cabinet is beyond the range ※3 shown below. Gap between drawer and cabinet beyond range ※3 shown below may cause unexpected damage to the slide

Self and Soft Closing

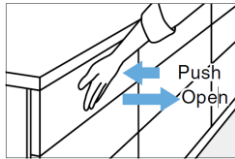

Full Extension (3 Members)

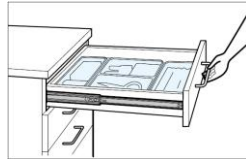

Easy to Detach

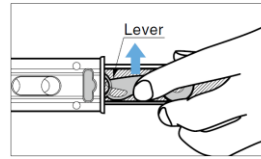

Simultaneously move the left lever upwards and the right lever downwards.

PAE ※1

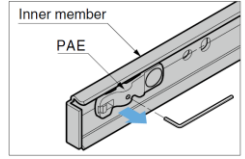

Turning the hex key (included) clockwise will cause the PAE to bulge in the direction of the arrow, which may reduce rattling when closed and expand the push-to-open area.

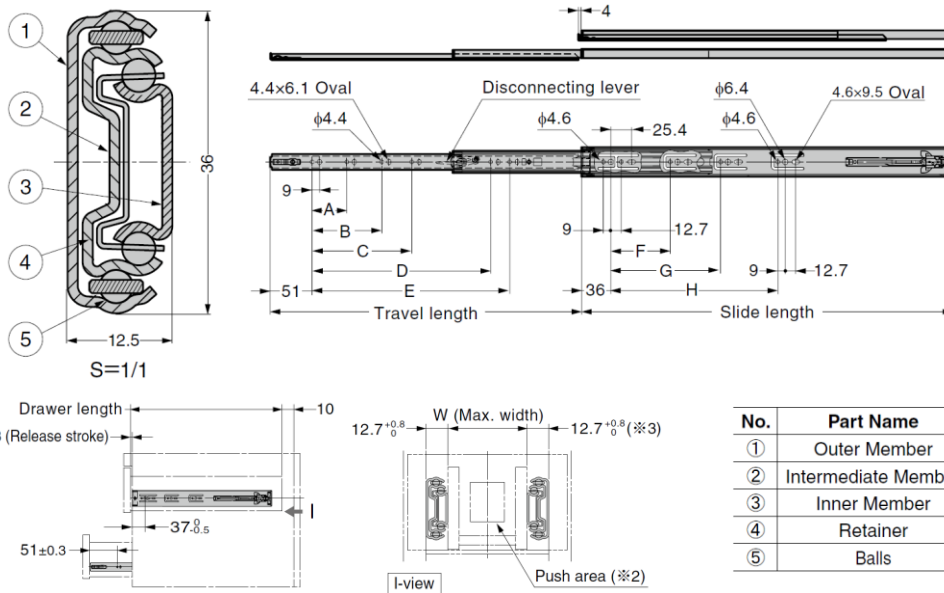

Sold in pairs

Part No.	Slide Length	Travel Length	A	B	C	D	E	F	G	H	W	Load Capacity (per pair)	
G3660-250	250	250	-	-	-	-	121	87	-	-	450	147 N	15 kg
G3660-300	300	300	71	-	-	-	171	-	-	-	500		
G3660-350	350	350	103	-	-	-	221	119	183	-	550	196 N	20 kg
G3660-400	400	400		231	-	-	271		199	600			
G3660-450	450	450		263	-	-	321		247	650			
G3660-500	500	500		167	295	-	371		215	295	700		
G3660-550	550	550		199	327	-	421		247	345	750		
G3660-600	600	600		-	-	-	391		471	247	375		